

GRB mixers[®]

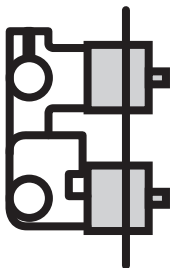

instrucciones termostáticos empotrar
built-in thermostatic instructions
instructions thermostatique à encastrer

GRB mixers[®]

Alaún 19, Pla-Za

50197 Zaragoza (Spain)

www.grbmixers.com · info@grb.es

040794.99



20 00900 19778 5



GRB is a Spanish Certified Product. CEE



Aspectos generales

Installation and assembly · Installation et montage



Primero, purgar las tuberías

First, drain pipes

Tout d'abord, purger la tuyauterie

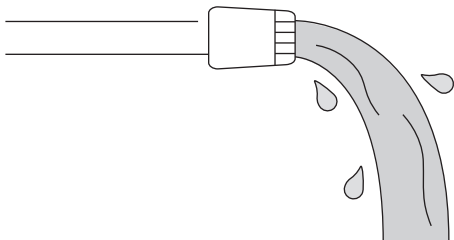

BAR 1
MIN

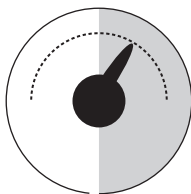

5 BAR
MIN

RECOMMENDED



Instalación y montaje

Installation and assembly · Installation et montage

1 Dimensiones · Dimensions · Mesures

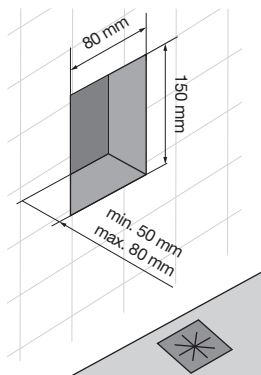

1 salida / 1 way / 1 voie

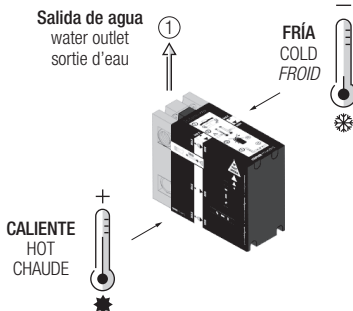

ATENCIÓN: no emplear las salidas selladas.
ATTENTION: do not use blocked outlets.
ATTENTION: ne pas utiliser les voies bloquées.

2 salidas / 2 ways / 2 voies

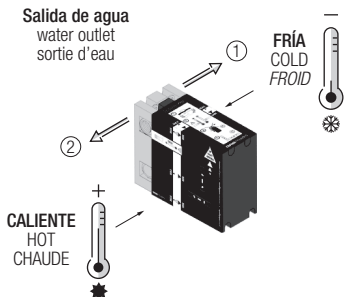

ATENCIÓN: no emplear las salidas selladas.
ATTENTION: do not use blocked outlets.
ATTENTION: ne pas utiliser les voies bloqués.

3 salidas / 3 ways / 3 voies

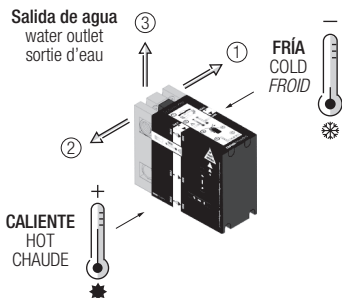

ATENCIÓN: no emplear las salidas selladas.
ATTENTION: do not use blocked outlets.
ATTENTION: ne pas utiliser les voies bloqués.

2 Max. Min.

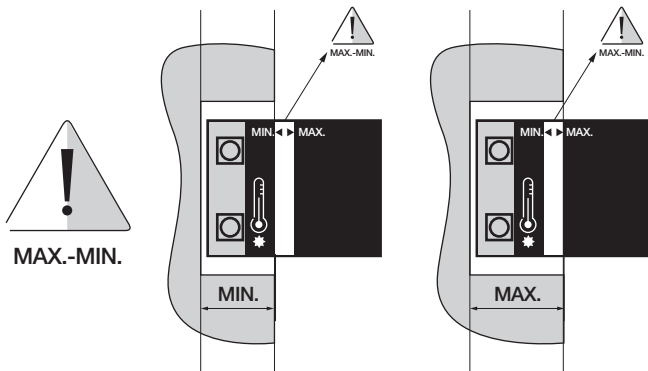

3 Nivelar · Level · Nivelez

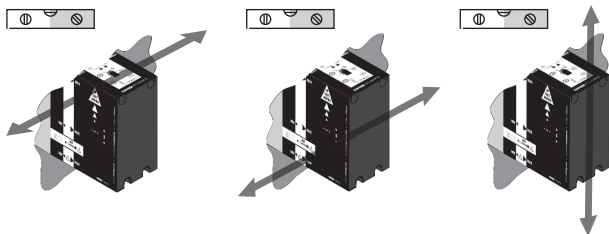

4 Alicatar · Shape · Carrez

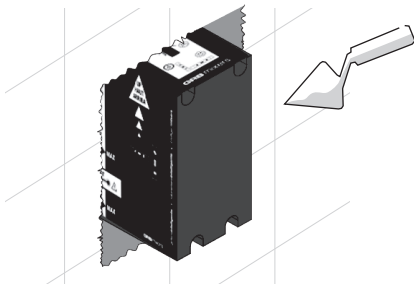

5 Retirar la espuma · Remove the foam · Retirez la protection

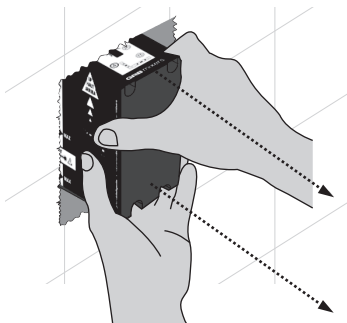

6 Colocación final · Colocación final · Colocación final

≡ OPCIÓN / OPTION A

133100, 134100, 145100, 137100, 154100,
136100, 133110, 134110, 145110, 132800,
142800, 146800, 137800, 135800, 136800,
40110400, 40120400, 40140400, 44110440,
44120440, 44130440

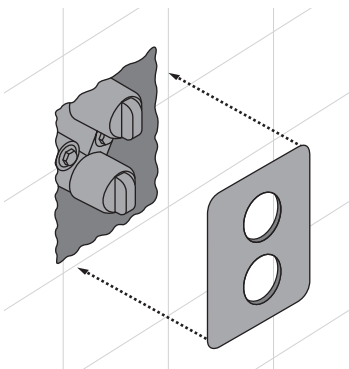
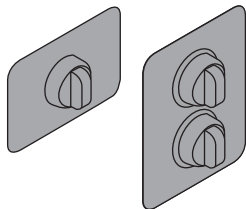

≡ OPCIÓN / OPTION B

140700, 142700, 145700, 50110500,
50120500, 50130500,

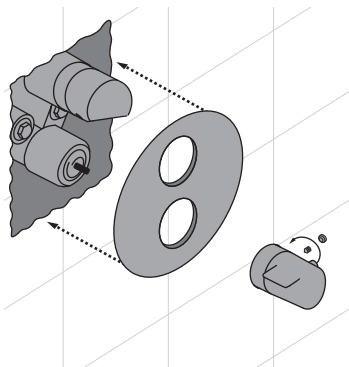
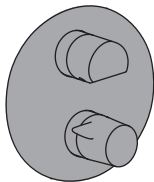

≡ OPCIÓN / OPTION C

132600, 142600, 146600, 135600, 147600,
140600, 50110500, 50120500, 50130500,
50170500, 140700, 142700, 145700, 137700,
50110520, 50120520, 50130520

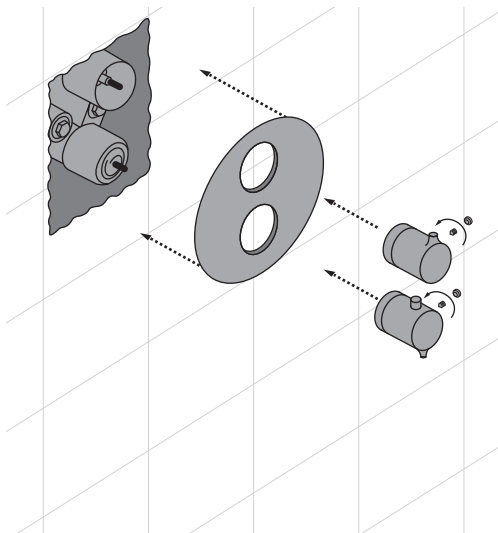
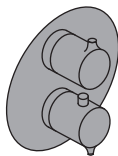

Por favor, compruebe que la maneta con pulsador va en la parte inferior y en esta posición.

Please, check that the handle with push-button is in the low place and in this position.

Merci de vérifier que la manette avec bouton est en bas et à cette position.

clásica · classical · classique

132190, 142190, 146190, 141190, 147300

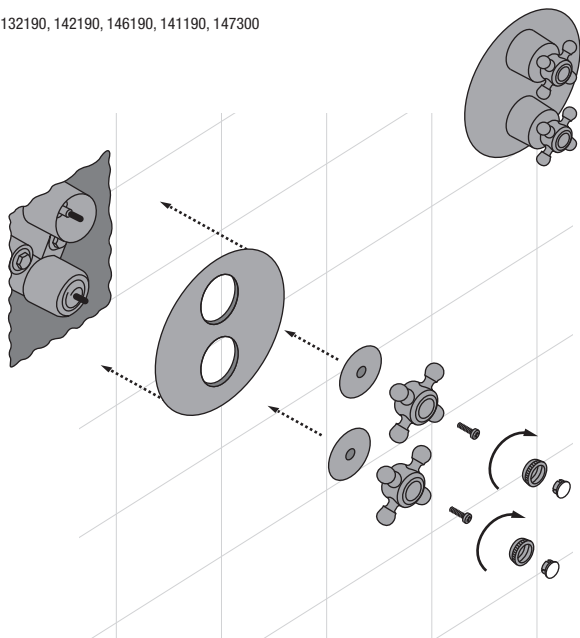



Posibles incidencias en la instalación

Possible incidents during the installation

Incidents possibles pendant l'installation

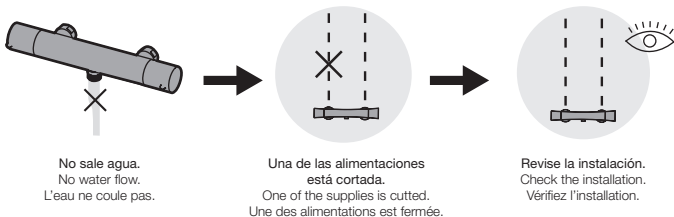
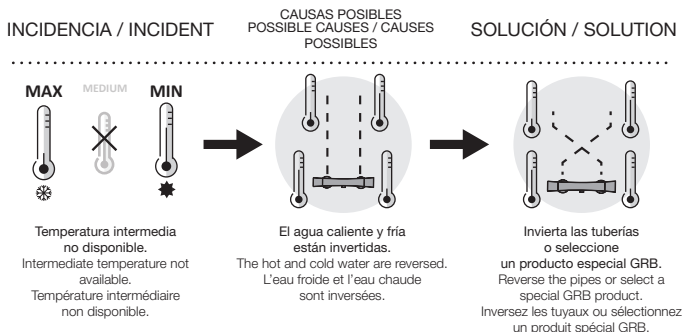

Tras un cambio o mantenimiento de la caldera, se recomienda purgar las tuberías y limpiar los filtros antes de utilizar cualquier grifería.

After a change or maintenance of the boiler, it's recommended to drain the pipes and to clean the filters before using any taps.

Après un changement ou un entretien de la chaudière, il est recommandé de purger les tuyaux et de nettoyer les filtres avant d'utiliser un robinet.

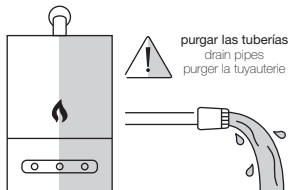



Instrucciones de uso

instructions for use · instructions d'utilisation

1 salida · 1 way · 1 voie

TEMPERATURA
TEMPERATURE

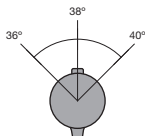

POSICIONES DESVIADOR
DIVERTER POSITIONS / POSITIONS DÉVIATEUR

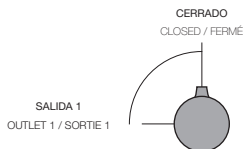

2 salidas · 2 ways · 2 voies

TEMPERATURA
TEMPERATURE

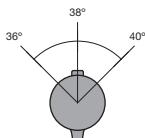

POSICIONES DESVIADOR
DIVERTER POSITIONS / POSITIONS DÉVIATEUR

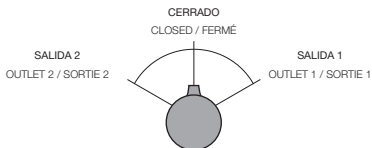

3 salidas · 3 ways · 3 voies

TEMPERATURA
TEMPERATURE

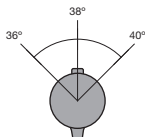

POSICIONES DESVIADOR
DIVERTER POSITIONS / POSITIONS DÉVIATEUR

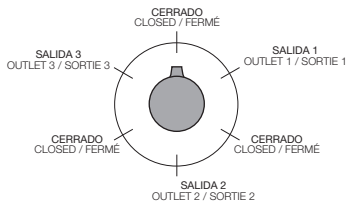



Limpeza y mantenimiento

Maintenance and cleaning · Nettoyage et maintenance



Clorhidric acid



Formic acid



Acetic acid

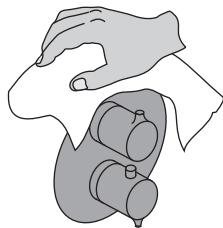
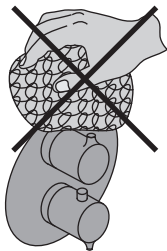
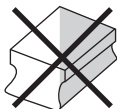

Mantenimiento. Maintenance. Maintenance.

1

Cerrar el agua.
Close the water.
Fermer l'eau.

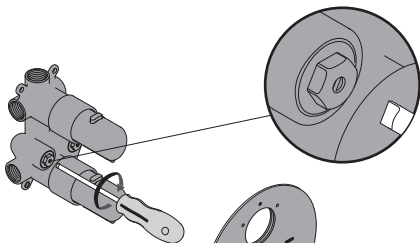

2

Acceder.
Component.
Accès.

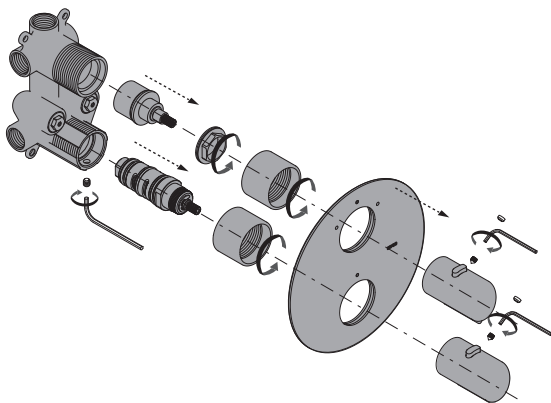

Limpeza de filtros. Clean filters. Nettoyage des filtres.

1

Cerrar el agua.
Close the water.
Fermer l'eau.

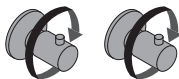

2

Limpiar los filtros.
Cleaning the filters.
Nettoyage des filtres.

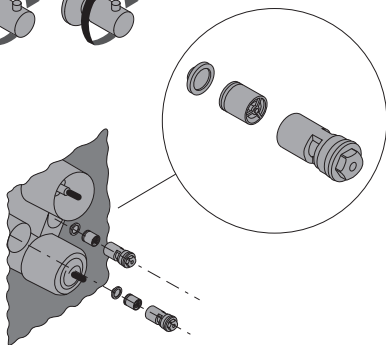

3

Purgar cuerpo/grifería.
drain the tap.
Ourgez la robinetterie.



4

Introducir los filtros en la
misma posición
Place the filters in the
same position.
Placer des filtres dans la
même position.

